

Plat of Survey

of

Lots 32 of Lackey Brothers' Subdivision of Williams Bay, Wisconsin,

located in the Southeast 1/4 of Section 1, Town 1 North, Range
16 East, Village of Williams Bay, Walworth County, Wisconsin.

Surveyed for: **Elmer Thogerson**
1316 Briar Court
Des Plaines, Illinois. 60018

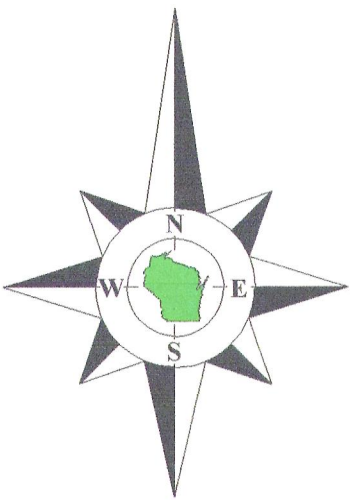

Bearings reference to previous
surveys of record.

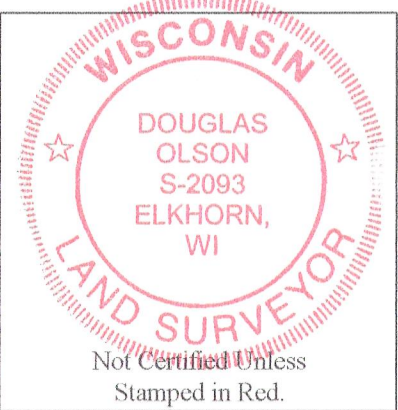

Notes:

- 1) This survey plat is not
certified unless signed
and sealed in red ink.
- 2) This survey is subject to Wisconsin lien laws.
This Plat of Survey is the notice of intent
to file lien. Lien waiver required.



Copyright 2011 by Jensen & Olson Land Surveying, LLC.

All rights reserved. No part of this survey plat may be reproduced or transmitted in
any form by any means - graphic, electronic, or mechanical, including photocopying,
tracing, or information storage and retrieval systems - without permission in writing
from Douglas G. Olson, Jensen & Olson Land Surveying, LLC.

I, Douglas G. Olson, Wisconsin Registered Land Surveyor, do hereby certify
that this survey was performed by me, or under my direction in full compliance with
the owner's/agent's instructions and Chapter A-E 7 of the Wisconsin Administrative
Code "Minimum Standards for Property Surveys"; and that this map is an accurate
representation thereof to the best of my knowledge and belief.

Douglas G. Olson
Wisconsin Registered Land Surveyor - 2093

Survey Date: August 25, 2011.
Revisions:

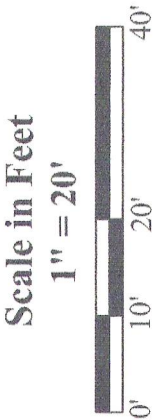

Jensen & Olson Land Surveying, LLC



45 South Wisconsin Street * P.O. Box 322 * Elkhorn, Wisconsin. 53121
Telephone: (262) 723-3434 * Facsimile: (262) 723-8044
Email: jensen.olson@elknet.net

Legend

- Found Iron Pipe
- Recorded Information
- Utility Pole
- Manhole
- Water Valve
- Asphalt Surface
- Concrete Surface
- Patio Blocks

Sheet 1 of 1 Sheets

Job Reference Number

2011.082

2011.082

WLB-32

011-2405